

overview

- distance measuring
- 0 ... 10 mm
- push-pull / IO-Link
- IO-Link
- connector M12
- 25 ... 75 °C
- IP 67



Technical data

general data

mounting type	flush
special type	linearized
type	distance measuring
measuring distance Sd	0 ... 10 mm
resolution	< 0,005 mm (High Accuracy Mode)
repeat accuracy	< 0,015 mm
adjustment	IO-Link
teach	Single point, Two point, Window
linearity error	± 40 µm (S = 0 ... 8 mm) ± 160 µm (S = 0 ... 10 mm)
temperature drift	± 3 % (Full Scale)
hysteresis	< 99 % (adjustable)
power on indication	LED green
output indicator	LED yellow

electrical data

response time (factory characteristic)	< 1 ms
switching frequency	< 800 Hz
voltage supply range +Vs	8 ... 36 VDC
current consumption max. (no load)	15 mA
output circuit	push-pull / IO-Link
output current	< 100 mA
short circuit protection	yes
reverse polarity protection	yes

communications interface

interface	IO-Link V1.1
baud rate	230,4 kBaud (COM 3)
cycle time	≥ 0,6 ms
process data length	32 Bit
process data structure	Bit 0 = SSC1 (distance) Bit 1 = SSC2 (distance) Bit 3 = alarm Bit 4 = SSC3 (frequency) Bit 5 = SSC4 (counter) Bit 16-31 = 16 Bit measurement

IO-Link port type

Class A

adjustable parameters

measuring range
switching point
switching hysteresis
measured value filtering
time filters
LED status indicators
output logic
output circuit
counter
deactivate the sensor element
Find Me function

additional data

distance
frequency
operating cycles
operating hours
boot cycles
operating voltage
device temperature
histograms

Technical data

mechanical data

type	cylindrical threaded
housing material	brass nickel plated
dimension	18 mm
housing length	60 mm

mechanical data

connection types	connector M12
tightening torque max.	40 Nm

ambient conditions

operating temperature	-25 ... +75 °C
protection class	IP 67

dimension drawing

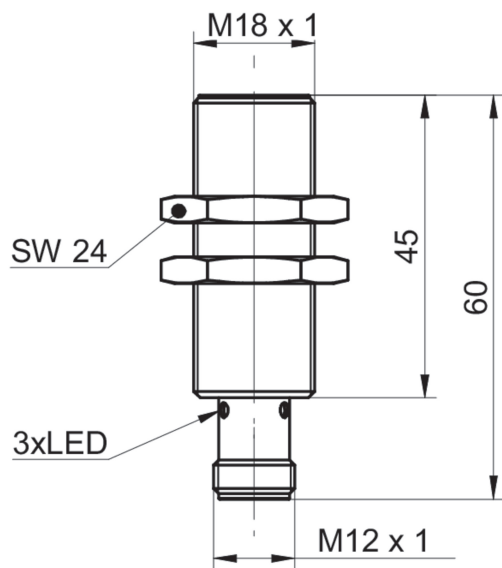

resolution

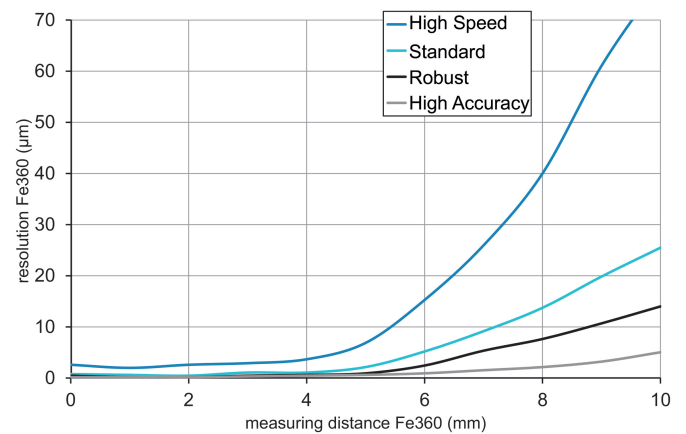

connection diagram

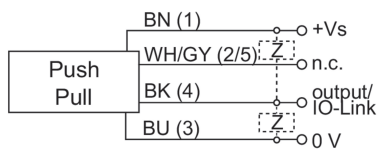

pin assignment

