

XCF10553

limit switch XCF - rod Ø 3.2 mm stainless steel
- 1C/O

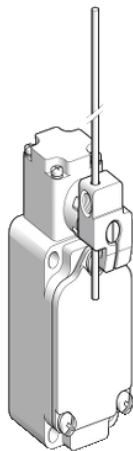

Main

Range of product	OsiSense XC
Series name	Asie
Product or component type	Limit switch
Product specific application	Heavy duty
Device short name	XCF
Body type	Fixed
Head type	Rotary head
Material	Metal
Fixing mode	By the body
Movement of operating head	Rotary
Type of operator	Spring return round rod lever stainless steel
Switch actuation	By any moving part
Type of approach	Lateral approach, 2 directions
Electrical connection	Screw-clamp terminals
Cable entry	1 entry tapped for G 1/2 cable gland
Number of poles	1
Contact operation	Snap action
Positive opening	Without
Maximum force for tripping	1.4 N

Complementary

Contacts insulation form	Za
Minimum release force	0.27 N
Maximum actuation speed	0.5 m/s
Maximum operating rate	60 cyc/mn
Maximum resistance across terminals	50 mOhm 6...8 V DC, 1 A
Dielectric strength	2000 V
Electrical durability	500000 cycles, DC, 6 A, 30 V
Mechanical durability	10000000 cycles
Width	40 mm
Height	69 mm
Depth	41 mm
Net weight	0.26 kg
Terminals description ISO n°1	(3-4-1-2)OF

Environment

Shock resistance	30 gn conforming to IEC 60068-2-27
Vibration resistance	1.5 mm double amplitude (f= 10...55 Hz) conforming to IEC 60068-2-6
IP degree of protection	IP66 conforming to IEC 60529 IP67 conforming to IEC 60529
Ambient air temperature for operation	-10...70 °C
Ambient air temperature for storage	-40...85 °C
Marking	CE

Product certifications	CSA UL recognized
Standards	UL 1054 IEC 60947-5-1 CSA C22.2 No 14

Packing Units

Package 1 Weight	1.000 kg
------------------	----------

Contractual warranty

Warranty	18 months
----------	-----------