

ifm electronic

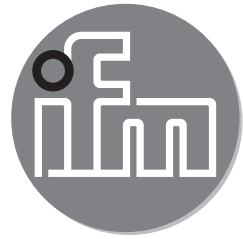

Installation instructions
Inductive sensor

efector100[®]

IOW

UK

704301 / 00 10 / 2007

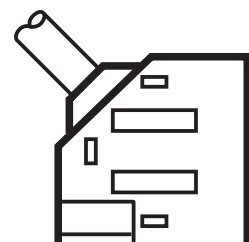
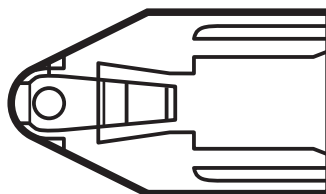

Functions and features

This sensor detects metals without contact and indicates their presence by providing a switched signal. Nominal sensing range (Sn) see type label.

Installation

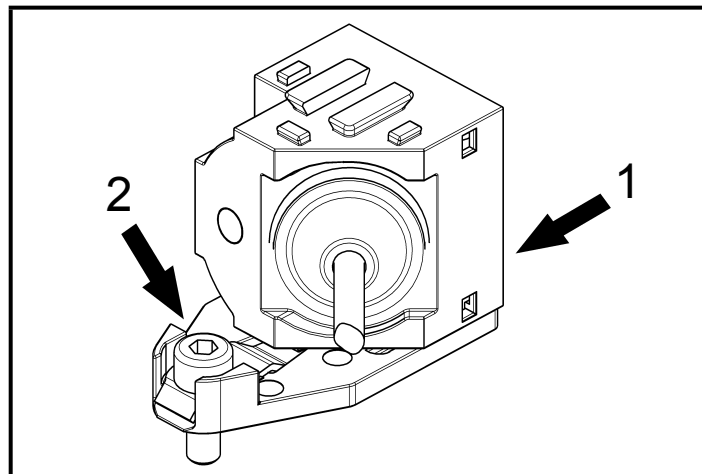
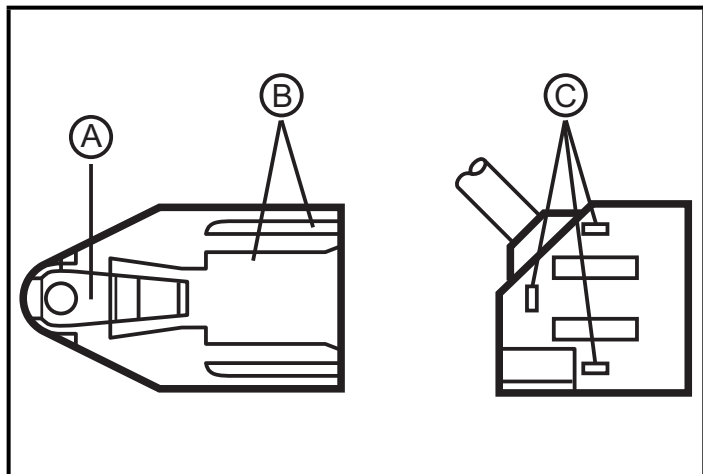

Ⓐ locking tab

Ⓑ guide rails

Ⓒ locating lugs

1. Slide the sensor on the mounting plate along the guide rails. To do so, slightly raise the screw and locking tab. If installed correctly, the sensor is flush with the mounting plate and the locking tab snaps into the locating lug.
2. Fix the mounting plate on the surface with the socket head screw (hole centres 25 mm). The locking tab fixes the sensor.

For units with connector this can be rotated by 270°.

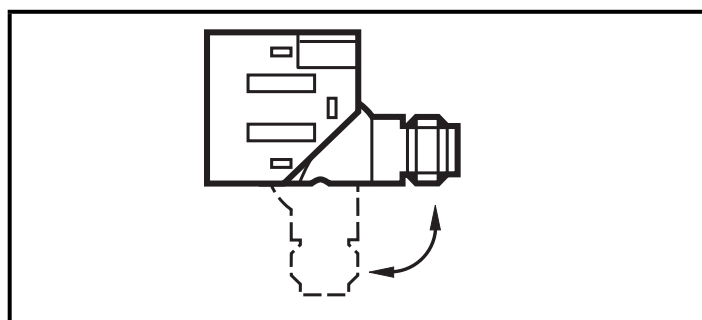

Possible alignment of the sensing face

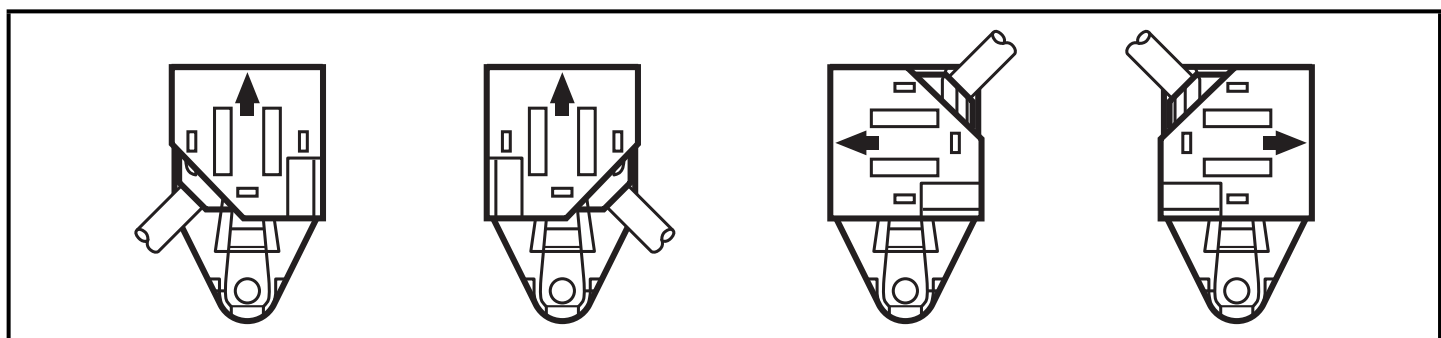

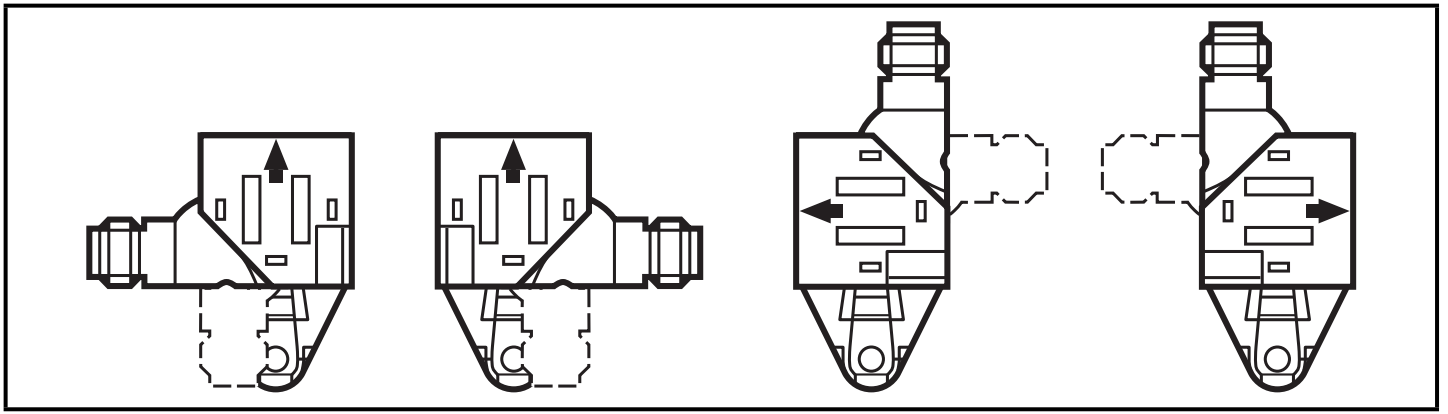

Removal

1. Loosen the screw.
2. Slightly raise the screw and locking tab while pulling the sensor away from the mounting plate.

Electrical connection



Disconnect power before connecting the unit. Connect the sensor according to the indications on the type label.

Operation

Check the safe functioning of the sensor. The LED is lit when the output is switched.

The operation of the sensor is maintenance-free. For a correct function ensure:

- that the sensing face and the clear space are kept free of metal deposits and foreign bodies, in particular for an installation with the sensing face facing upwards.
- EMC: The unit complies with the requirements according to EN 60947-5-2.