

ifm electronic

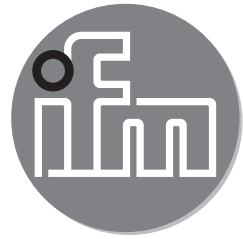

Operating instructions /
Mounting instructions
Flow sensor

UK

efector300®

SP321A

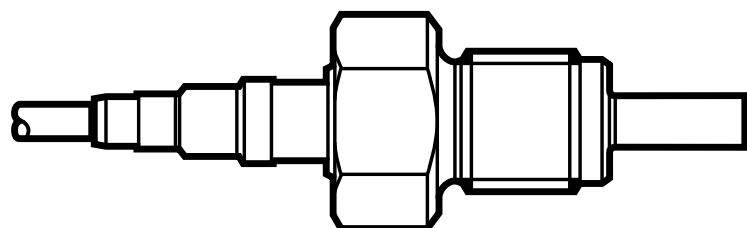

706051 / 00 12 / 2011



Before installation, read the safety-related section of the operating instructions, enclosed separately!

Installation

The sensor tip must be completely immersed in the medium.

- In the case of horizontal pipes mount the unit from the side, if possible (fig. 1).
 - When the unit is to be mounted at the bottom of the pipe, it should be free from deposits.
 - When the unit is to be mounted at the top of the pipe, it should be completely filled with the medium to be monitored.
- In the case of vertical pipes mount the unit in a place where the medium flows upwards (fig. 2).

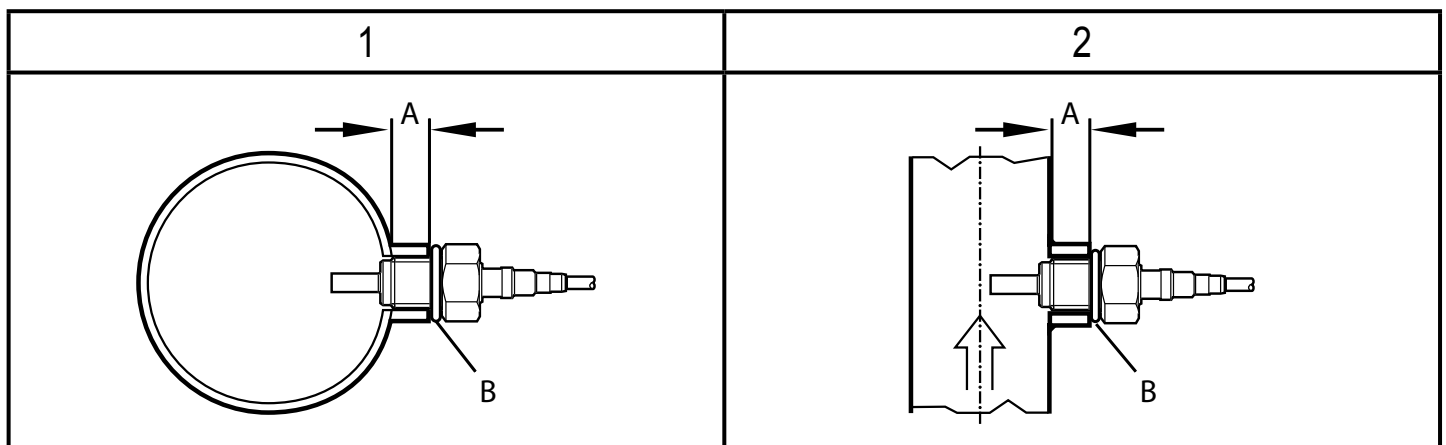

A: mounting bush (25 mm).

B: packing washer

To avoid malfunction a minimum distance between the flow monitor and bends, valves or such like must be observed (fig 3).

Min. 5 x pipe diameter upstream (A),
min. 3 x pipe diameter downstream (B).

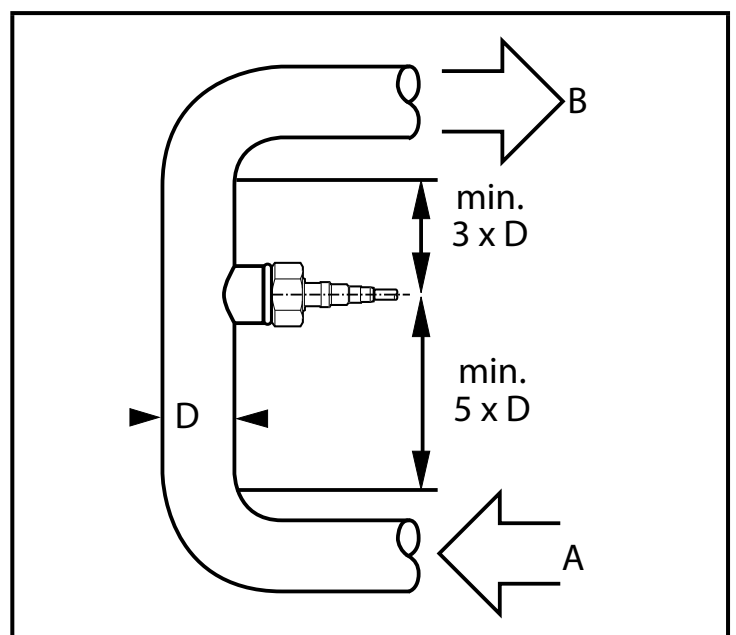

Scale drawings

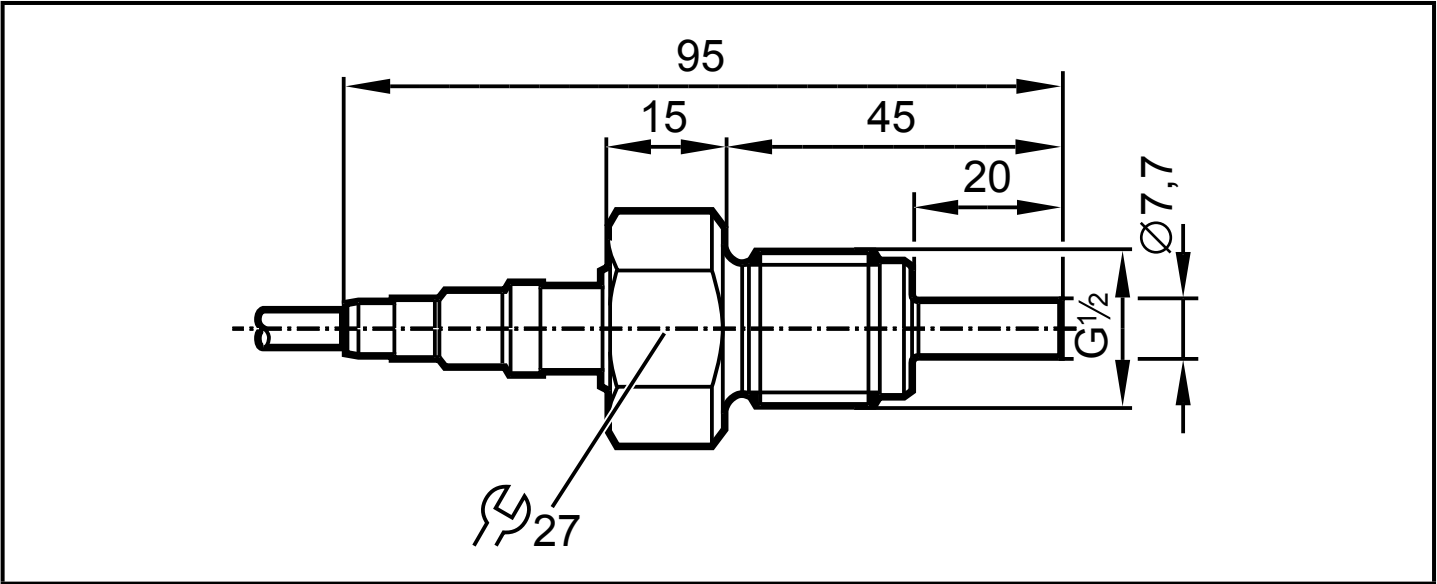

UK