

ifm electronic

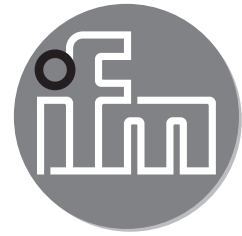

Installation Instructions
Adapter

efector500[®]

E30116

UK

05/2011

706015/00

ifm electronic gmbh • Friedrichstr. 1 • 45128 Essen • Germany
<http://www.ifm.com> • e-mail: info@ifm.com

Mounting sensor - adapter

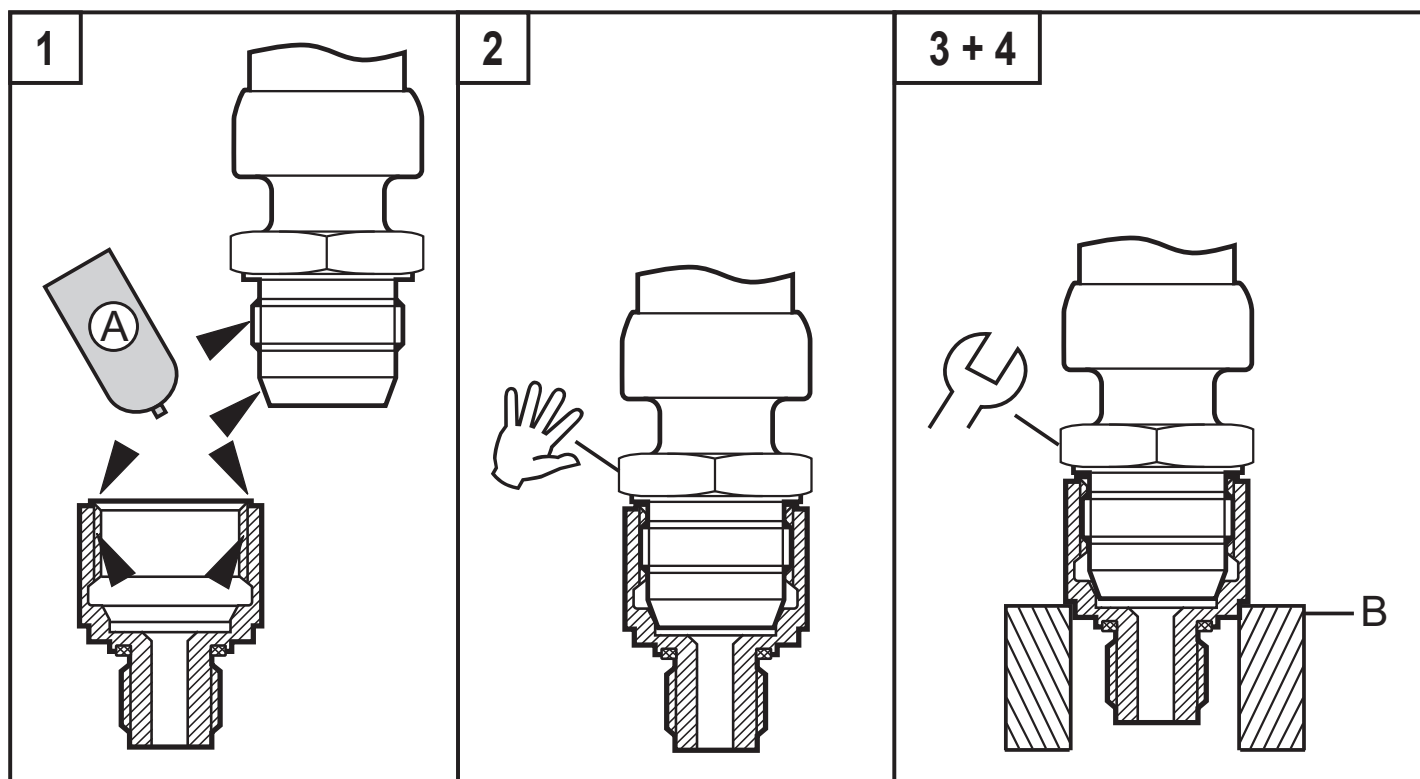

- ▶ Slightly grease the threads and sealing areas of the sensor and adapter with the lubricating paste (A).
The paste must be suitable and approved for the application and compatible with the elastomers used.
- ▶ Screw the sensor into the adapter until it is hand-tight.
- ▶ Clamp sensor and adapter into a clamping device (B).
Tighten the clamping device only slightly so that the adapter does not warp.
- ▶ Tighten the sensor using a spanner (tightening torque: 20 Nm).

Technical data and further information at www.ifm.com