



Indicative image



### M30 CYLINDRICAL DIRECT DIFFUSE & RETRO-REFLECTIVE ULTRASONIC SENSOR WITH TEACH-IN BUTTON

- M30 ultrasonic sensor with standard housing and with large front with high performances and high sensing distances
- Adjustable hysteresis function: models with double digital programmable output specific for level detection
- Models with voltage or current output: programmable slope to optimize resolution
- Adjustable working area (window mode or object mode) by Teach-in button on all models for a quick and easy installation
- Two multifunction LEDs: orange LED for adjustment procedure and output type and green LED for target alignment
- Plastic and AISI 316L stainless steel housing, plug M12 or cable exit 4 pin

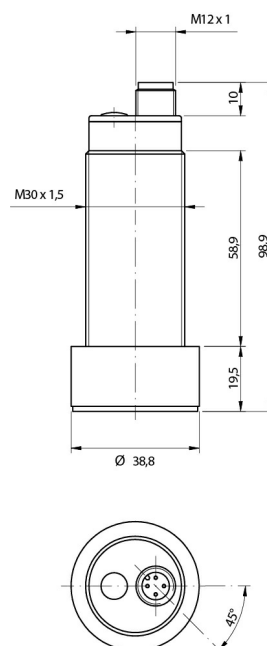

## ELECTRICAL DIAGRAMS OF THE CONNECTIONS

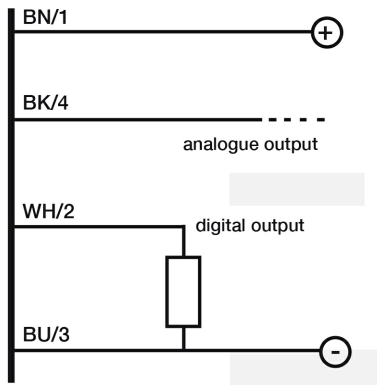

# CONNECTOR

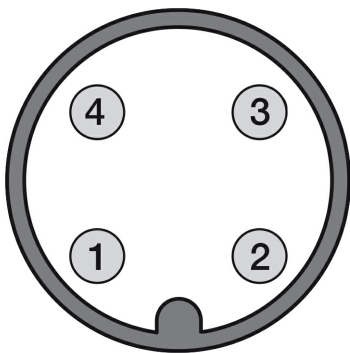

# RESPONSE CURVES

## Parallel offset

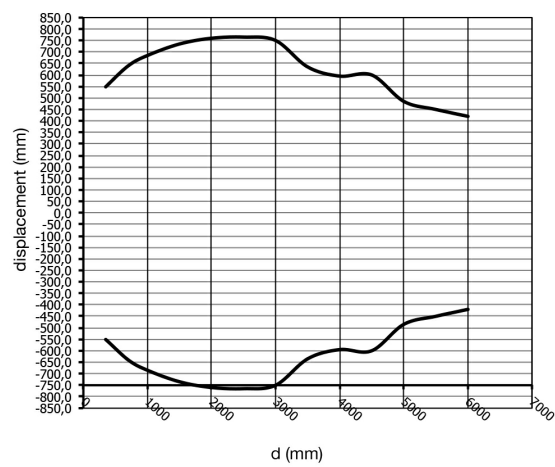

Tel. 059 420411  
Fax 059 253973  
E-mail [info@datasensing.com](mailto:info@datasensing.com)