

## IFRM 12N13T1/PL

Inductive proximity switch - outdoor and washdown

Article number: 11016681

### overview

- 6 mm
- NPN make function (NO)
- cable PUR 3 x 0,25, 2 m
- -40 ... 80 °C
- IP 67



### Technical data

#### general data

mounting type	non-flush
special type	Outdoor design
nominal sensing distance S <sub>n</sub>	6 mm
hysteresis	2 ... 15 % of S <sub>r</sub>
output indicator	LED red

#### electrical data

switching frequency	< 2 kHz
voltage supply range +V <sub>s</sub>	10 ... 30 VDC
current consumption max. (no load)	10 mA
output circuit	NPN make function (NO)
voltage drop V <sub>d</sub>	< 2 VDC
output current	< 200 mA

#### electrical data

short circuit protection	yes
reverse polarity protection	yes

#### mechanical data

type	cylindrical threaded
material (sensing face)	PBT
housing material	brass nickel plated
dimension	12 mm
housing length	50 mm
connection types	cable PUR 3 x 0,25, 2 m
tightening torque max.	15 Nm (Front: 10 Nm)

#### ambient conditions

operating temperature	-40 ... +80 °C
protection class	IP 67

## IFRM 12N13T1/PL

Inductive proximity switch - outdoor and washdown

Article number: 11016681

### dimension drawing

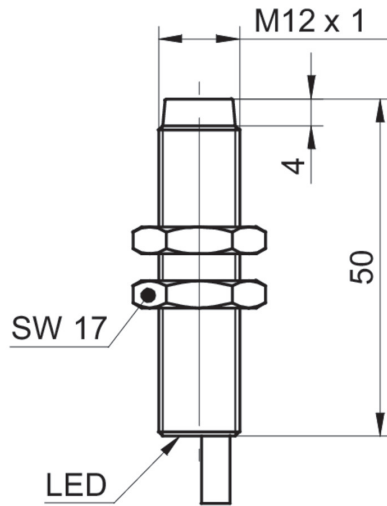

### connection diagram

