

## overview

- Outstanding reliability and unrivalled immunity against ambient light
- Baumer PinPoint LED: Small, homogeneous light spot with sharp edges
- IO-Link interface independent of the switching output (Dual Channel)
- Extended parameterization options and additional diagnostic data
- Quick mounting by means of M3 threaded bushes made of stainless steel



Picture similar



## Technical data

### general data

type	background suppression
version	IO-Link dual channel
light source	pulsed PinPoint LED
sensing distance Tw	20 ... 120 mm
sensing range Tb	3 ... 132 mm
alignment / soiled lens indicator	flashing output indicator
power on indication	LED green
output indicator	LED yellow
sensing distance adjustment	IO-Link
wave length	644 nm
suppression of reciprocal influence	yes
beam type	point
alignment optical axis	< 1,5°

### electrical data

response time / release time	< 0,4 ms (High Speed Mode)
jitter	< 0,21 ms (High Speed Mode)
voltage supply range +Vs	10 ... 30 VDC
current consumption max. (no load)	45 mA (@ 10 VDC)
current consumption typ.	16 mA (@ 24 VDC)
voltage drop Vd	< 2 VDC

### electrical data

output function	light / dark operate
output circuit	push-pull
output current	< 50 mA
short circuit protection	yes
reverse polarity protection	yes

### communication interface

baud rate	38,4 kBaud (COM 2)
adjustable parameters	switching point switching hysteresis time filters LED status indicators output logic output circuit counter operation mode deactivate the sensor element Find Me function Teach-in mode
IO-Link port type	Class A
process data length	32 Bit
process data structure	Bit 0 = SSC1 (presence) Bit 2 = quality Bit 3 = alarm Bit 5 = SSC4 (counter) Bit 16-31 = 16 Bit measurement
interface	IO-Link V1.1

## O200.GP-GW2I.72CV/A014\_H006

Diffuse sensors with background suppression - miniature

Article number: 11230696

### Technical data

#### communication interface

additional data	excess gain
	operating cycles
	device temperature

cycle time	≥ 2,7 ms
------------	----------

#### mechanical data

width / diameter	8 mm
height / length	25,1 mm
depth	15,8 mm
type	rectangular

#### mechanical data

mechanical mounting	threaded sleeves M3 (stainless steel)
housing material	plastic (ASA, PMMA)
front (optics)	PMMA
connection types	cable 4 pin, 2 m
cable characteristics	PVC / PVC 4 x 0,08 mm <sup>2</sup>

#### ambient conditions

operating temperature	-25 ... +50 °C
protection class	IP 67

### dimension drawing

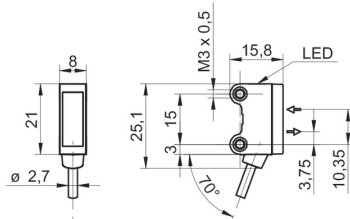

### connection diagram

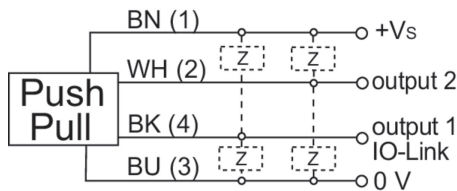

### beam characteristic (typically)

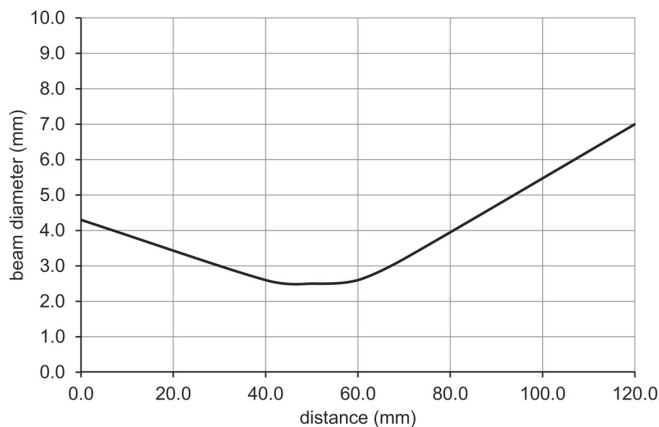

### sensing distance diagram

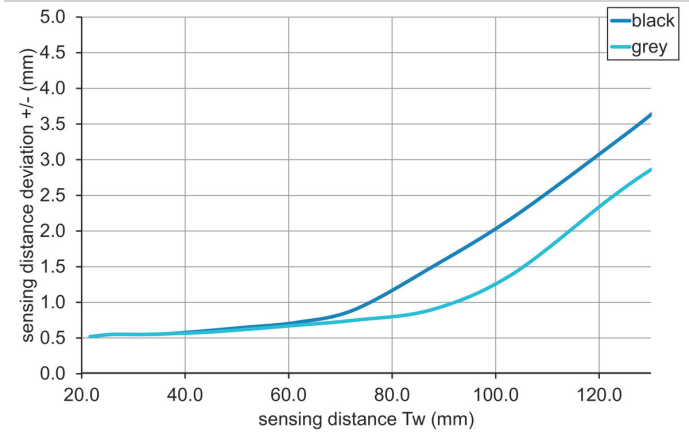

### hysteresis curve

