

ifm electronic

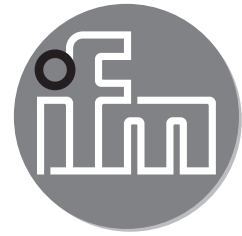

Installation Instructions
Adapter

efector500®

E30131

UK

05/2011

706005/00

ifm electronic gmbh • Friedrichstr. 1 • 45128 Essen • Germany
<http://www.ifm.com> • e-mail: info@ifm.com

Mounting sensor - adapter

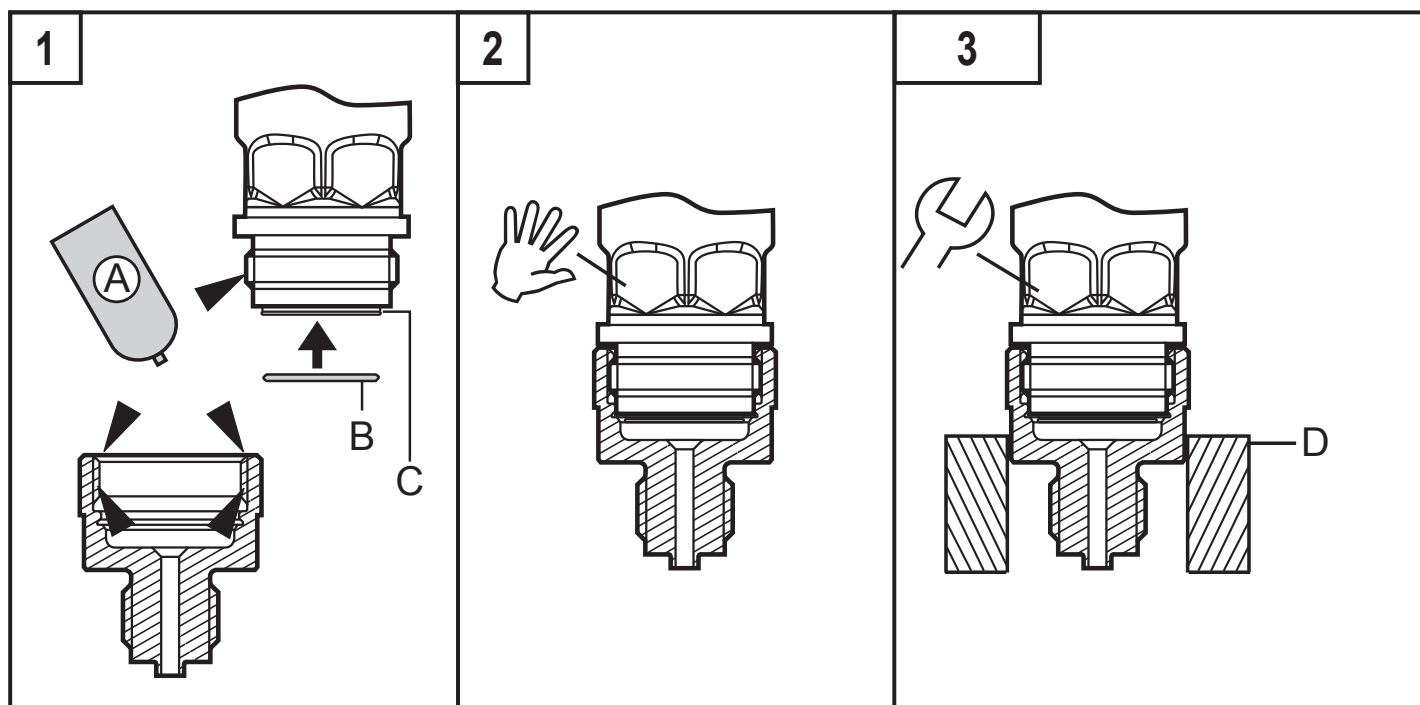

- ▶ Slightly grease the threads and sealing areas of the sensor and adapter with the lubricating paste (A).
The paste must be suitable and approved for the application and compatible with the elastomers used.
- ▶ Place the sealing ring (B) in the groove (C) of the sensor.
The adapter is supplied with an EPDM O-ring. More sealing rings are available as accessories: FKM O-ring, order no. E30123.
- ▶ Screw the sensor into the adapter until it is hand-tight.
- ▶ Clamp the sensor + adapter into a clamping device (D). Tighten the clamping device only slightly so that the adapter does not warp.
- ▶ Tighten the sensor using a spanner until you can feel the end stop (this corresponds to a maximum tightening torque of 35 Nm). Note: Further tightening may affect the sealing effect.

Technical data and further information at www.ifm.com