

ifm electronic

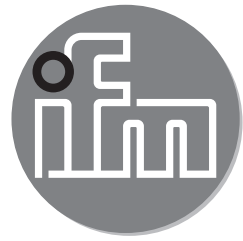

Installation instructions

Protective cap
for pressure sensors

E30148

UK

80236234 / 00 02/2016

1 Information

The filter cover or the tube adapter can be used for sensors with fitted pressure compensation element. The following illustrations are examples of pressure sensors with pressure compensation element fitted.

2 Sample illustration for removal of the filter cover



Ensure that the sensor is not subjected to moisture during installation of the filter cover!

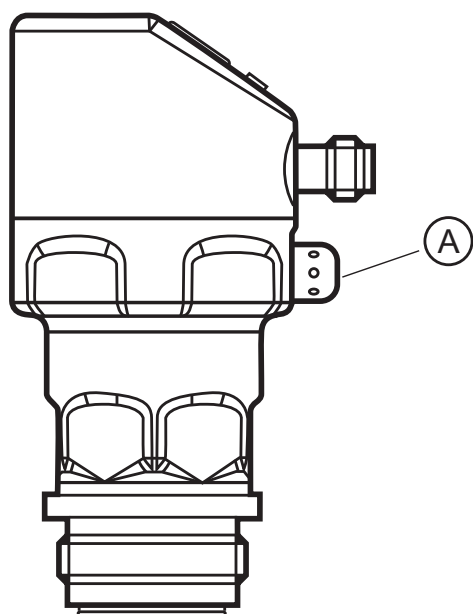

► Remove the filter cover (A) using an appropriate tool.

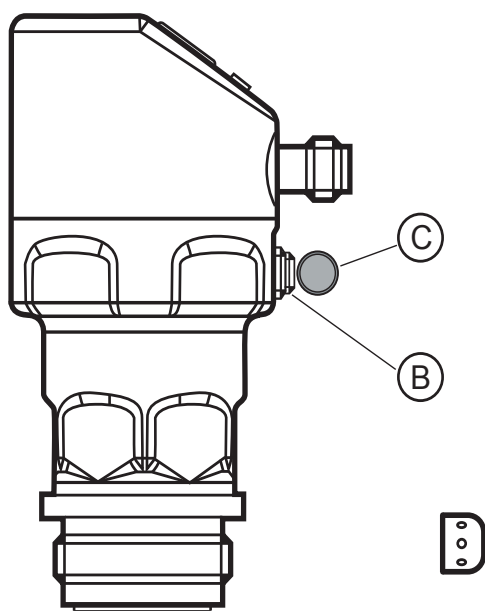

► Pull the Teflon diaphragm (C) off the base (B).



The sensor has been prepared for the installation of the protective cap E30148.

3 Installation protective cap

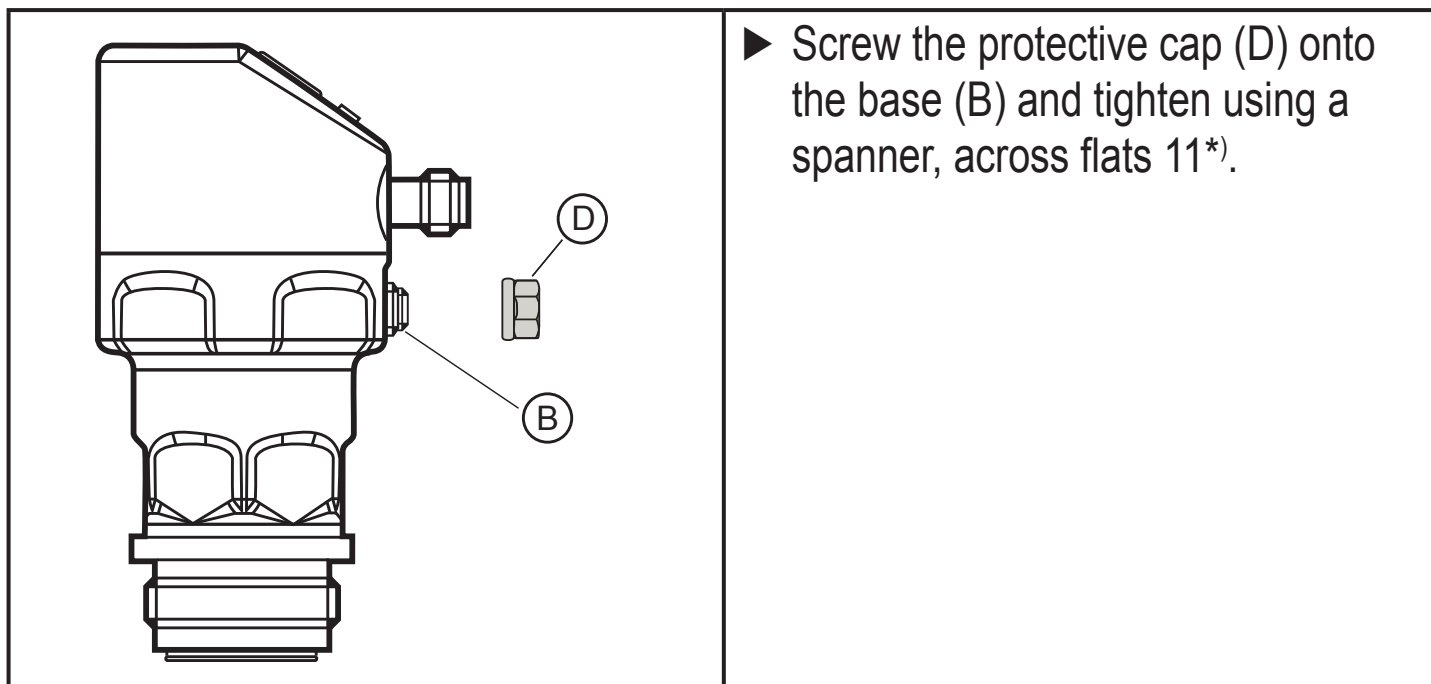

*) Tightening torque 2.5...3.5 Nm!



The protective cap does not allow any pressure compensation of the relative pressure sensor.

When using the protective cap please note:

- pressure compensation of the relative pressure sensor is inhibited
- the internal pressure of the sensor changes by 35 mbar for every 10 K of temperature change.

► Please ensure that the application is suitable for use without the pressure compensation being active!



The protective cap is only recommended for:

- harsh environmental conditions
- applications where decreased accuracy is accepted